

Dometic RV Toilet Floor Flange Adapter Kit 4-bolt to 2-bolt toilet mounting instructions

Kit includes:

- 1 - mounting adapter
- 1 - flange surround
- 8 - #12x1.5-inch screws

This kit adapts four-bolt floor flanges of some factory-installed toilets for easy installation of two-bolt-style Dometic® toilets. Before starting, be sure the toilet fits in the required space.

1. Remove old toilet and floor flange seal. Leave two original mounting bolts in the floor flange (fig.1).
2. Using the location holes provided, place mounting adapter over two original mounting bolts with the words "THIS SIDE UP" showing (fig. 2).
3. Drill 1/8-inch (3 mm) pilot holes in eight holes closest to the mounting bolt slots. Pilot holes should be drilled through the original floor flange and subfloor (fig. 3). Pilot hole depth should not exceed 1.5 inches (38 mm).
4. If floor is carpeted, trim carpet to outside edge of the flange surround. (If the floor is not carpeted, proceed to step 5). Place the surround around the floor flange (shown in fig. 5). Use a utility knife (preferably) with a new blade to trim the carpet closely to the flange surround.

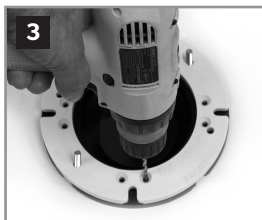

5. Lift the new mounting adapter off the floor flange and set aside. Remove and discard the original mounting bolts and nuts.
6. Turn the new mounting adapter over and apply a 1/4-inch bead of silicone caulk around the inside circumference of the adapter (fig. 4).
7. Position the new mounting adapter as it was done in Step 2. Make sure the holes drilled into the floor flange in Step 3 line up with the new mounting adapter.
Secure the mounting adapter in place with the eight #12x1.5-in. screws supplied.
8. Insert two new toilet mounting bolts (supplied with new toilet) into the appropriate slots of the mounting adapter.
Place the flange surround around the mounting adapter/floor flange assembly (fig. 5).
9. The floor flange is now ready for installation of the new toilet.

NOTE: If a water supply line extension is needed, you can buy the necessary parts at your dealer or hardware store.



REVISION A

Form No. 600346525 8/17
©2017 Dometic Corporation

 **DOMETIC**

Dometic Corporation, Sanitation Division
13128 State Rt. 226, P.O. Box 38
Big Prairie, OH 44611 USA
1-800-321-9886 • Fax: 330-496-3097
www.Dometic.com